

# REPLACEMENT PARTS SUITABLE FOR HYPERTHERM®

## HT400®

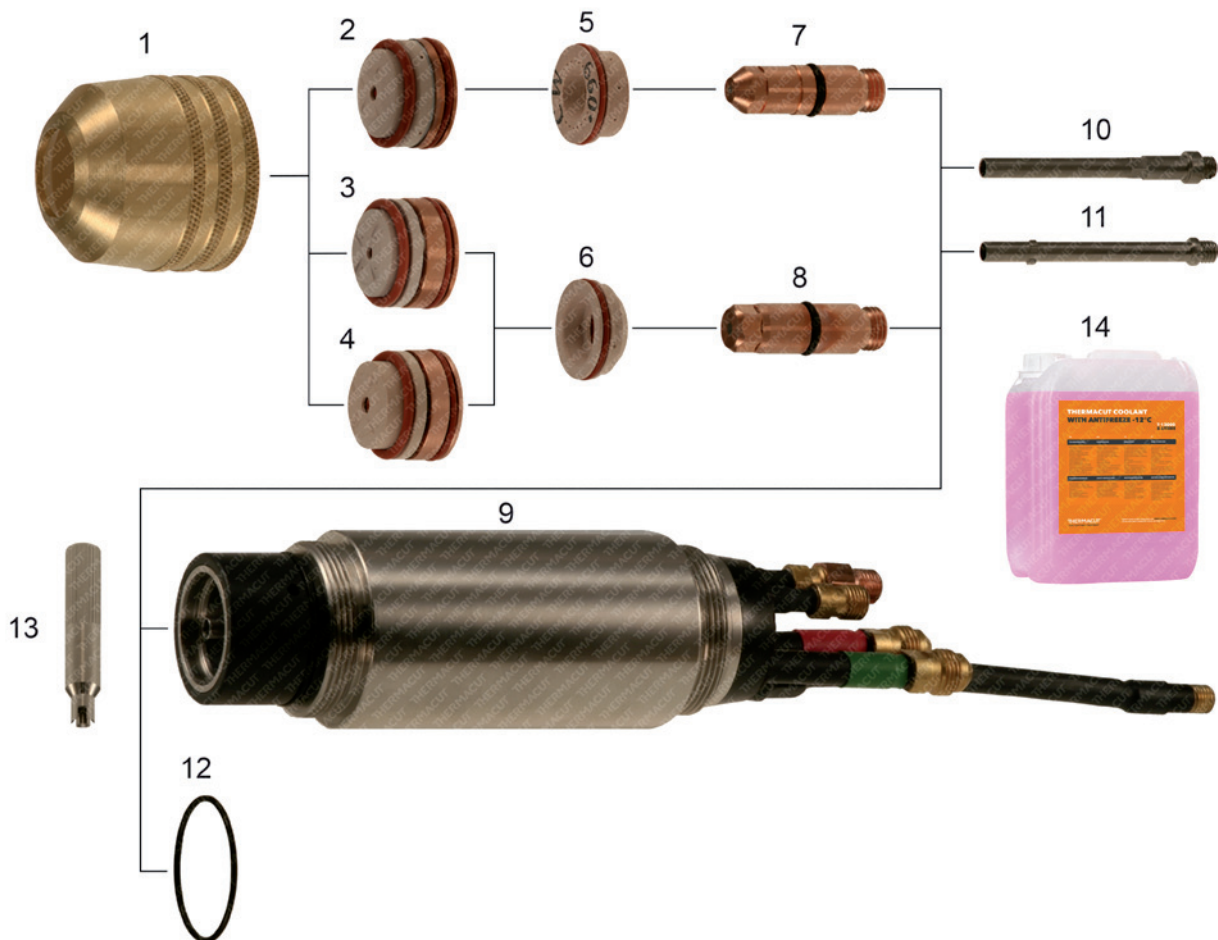

Item	Part No.	Ref. No.	Description	Std. Pkg.	Item	Part No.	Ref. No.	Description	Std. Pkg.
1.	T-0088	020579	Retaining Cap	1	**11.	T-1388**	020990-UR	Water Tube (For TMT Torch)	1
2.	T-0078	020086	Nozzle 260A, 340A, O <sub>2</sub>	1	12.	T-1006	044028	O-Ring	1
3.	T-0079	020089	Nozzle, .120, N <sub>2</sub>	1	13.	T-1397	T-1397	Wrench for TMT Water Tube	1
4.	T-0080	020084	Nozzle, .166, N <sub>2</sub>	1	NS	KT-1214	028139	HT400®, PAC500® Cable Leads, 6,1m (20')	1
NS	T-1795	020392	Nozzle .099, O <sub>2</sub> , CCW	1	NS	KT-1154	028140	HT400®, PAC500® Cable Leads, 7,6m (25')	1
NS	T-2928	120385	Nozzle 260A, O <sub>2</sub> , Bevel, CCW	1	NS	KT-1157	028141	HT400®, PAC500® Cable Leads, 9,2m (30')	1
5.	T-0081	020096	Swirl Ring, O <sub>2</sub>	1	NS	KT-1153	028142	HT400®, PAC500® Cable Leads, 10,7m (35')	1
	T-0087	020097	Swirl Ring, O <sub>2</sub> , CCW	2	NS	KT-1404	028143	HT400®, PAC500® Cable Leads, 12,2m (40')	1
6.	T-0020	020039	Swirl Ring, .120/.166/.187, N <sub>2</sub>	1	NS	KT-1217	K.HT400.15,2M.K	HT400®, PAC500® Cable Leads, 15,2m (50')	1
7.	T-0083	020081	Electrode, O <sub>2</sub>	5	NS	KT-1058	K.HT400.10,7M	HT400® Mach. Torch with Leads 10,7m (35')	1
8.	T-0084	020082	Electrode, N <sub>2</sub>	5	14.			Coolant Liquid. Details on the page 148, section Accessories.	
9.	T-0085	020080	Torch Body HT400®	1				Different types of cable leads available on request	
#10.	T-1389#	020990 OEM	Water Tube (For OEM Torch)	1					

# COMPATIBLE WITH OEM TORCH ONLY, DOESN'T FIT TO THERMACUT TORCH

\*\* COMPATIBLE WITH THERMACUT AND OEM TORCH

NS NOT SHOWN IN THE PICTURE

CCW COUNTER CLOCK WISE GAS SWIRLING, USE OF CCW PARTS WILL MAKE CUT ANGLE ON THE OPPOSITE SIDE, THAN WITH STANDARD CLOCK WISE (CW) SWIRLING PARTS.

**Last update of this page: 11/04/2016. See Revision history for details.**

**THERMACUT®**  
THE CUTTING COMPANY

WWW.THERMACUT.CZ  
TEL.: +420 556 423 418  
SALES@THERMACUT.CZ

WWW.THERMACUT.DE  
TEL.: +49 (0) 27 39 40 33 0  
INFO@THERMACUT.DE

WWW.THERMACUT.COM  
TEL.: 1-603-542-6715  
CUSTOMERSERVICE@THERMACUT.COM

THERMACUT®, FHT-EX® AND EX-TRAFIRE® ARE REGISTERED TRADEMARKS OF THERMACUT S. R. O. AND MAY BE REGISTERED IN CZECH REPUBLIC AND/OR OTHER COUNTRIES. ALL OTHER TRADEMARKS ARE PROPERTIES OF THEIR RESPECTIVE OWNERS. THERMACUT IS NO WAY AFFILIATED WITH HYPERTHERM®. MOST THERMACUT PARTS ARE MADE FOR OR BY AN IBG COMPANY. PARTS INDICATED WITH A OEM ARE ORIGINAL PARTS MANUFACTURED BY THE ABOVE NAMED MANUFACTURER AND ARE BEING RESOLD BY THERMACUT. THERMACUT RESERVES THE RIGHT TO SUBSTITUTE OEM PARTS IN PLACE OF THERMACUT PARTS. VALID FROM MAY 2016 • PREVIOUS VERSION IS NO LONGER VALID. • © COPYRIGHT 2016 BY THERMACUT® CZECH REPUBLIC. ALL RIGHTS RESERVED.