

REPLACEMENT PARTS SUITABLE FOR CEBORA®

HP100®, MP100®

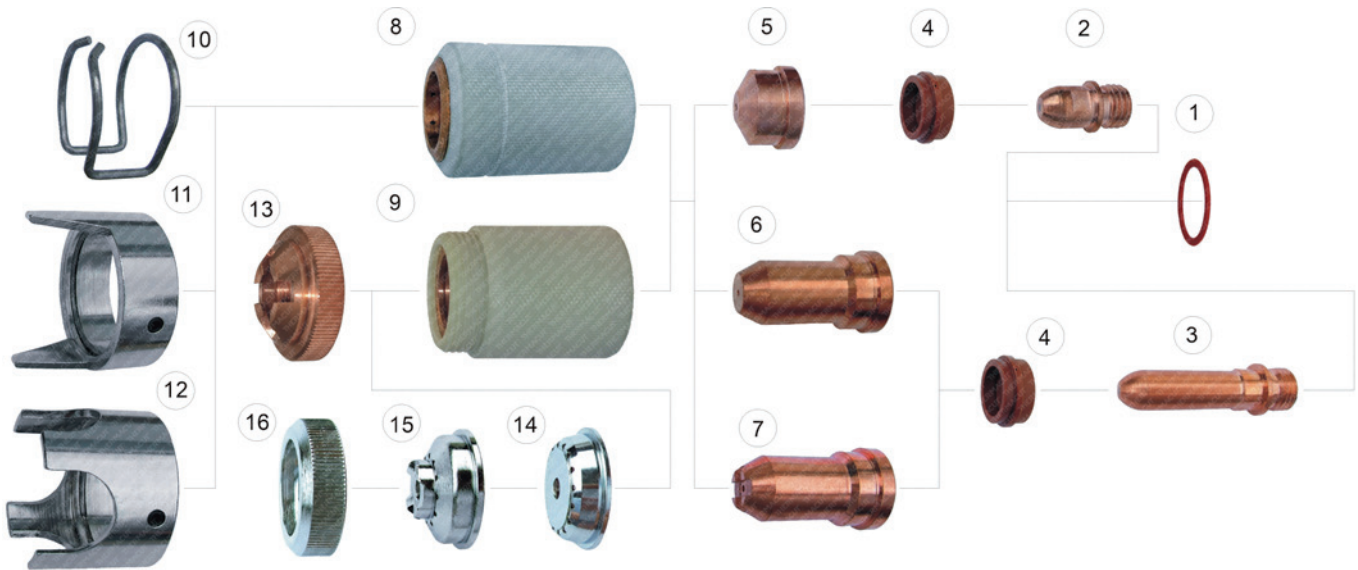

Item	Part No.	Ref. No.	Description	Item	Part No.	Ref. No.	Description
1.	T-0411	1398	O-Ring	8.	T-5432	W0300129	Retaining Cap HP100
2.	T-0408	1376	Electrode	9.	T-5433	W0300138	Contact Nozzle Ret. Cap HP, MP100
3.	T-0409	1517	Electrode, Long	10.	T-0400	1386	Spacer Spring
4.	T-0407	1377	Swirl Ring	11.	T-0643	1408	Double Pointed Spacer
	T-8959	1377-CW	Swirl Ring	12.	T-5003	CV14	Crown Spacer
5.	T-0402	1371	Nozzle 1.1mm	13.	T-5401	1392	Shield Cup, Only for W0300138
	T-0403	1372	Nozzle 1.3mm	NS	T-5442	1356	Handle with Switch
	T-0404	1373	Nozzle 1.6mm	14.	T-9372		Shield Cup, Machine
	T-0405	1374	Nozzle 1.8mm HP, MP150	15.	T-9370		Spacer for Contact Cutting
6.	T-11041	1369.16	Nozzle, Long D1,6 – 120A	16.	T-9375		Locking Nut
7.	T-0406	1369	Nozzle, Long, Contact				

Last update of this page: 24/02/2014. See Revision history for details.

THERMACUT®
THE CUTTING COMPANY

WWW.THERMACUT.CZ
TEL.: +420.556 423 418
SALES@THERMACUT.CZ

WWW.THERMACUT.DE
TEL.: +49 (0) 27 39 40 33 0
INFO@THERMACUT.DE

WWW.THERMACUT.COM
TEL.: 1-603-542-6715
CUSTOMERSERVICE@THERMACUT.COM

THERMACUT®, FHT-EX® AND EX-TRAFIRE® ARE REGISTERED TRADEMARKS OF THERMACUT S. R. O. AND MAY BE REGISTERED IN CZECH REPUBLIC AND/OR OTHER COUNTRIES. ALL OTHER TRADEMARKS ARE PROPERTIES OF THEIR RESPECTIVE OWNERS. THERMACUT IS NO WAY AFFILIATED WITH CEBORA®. MOST THERMACUT PARTS ARE MADE FOR OR BY AN IBG COMPANY. PARTS INDICATED WITH A OEM ARE ORIGINAL PARTS MANUFACTURED BY THE ABOVE NAMED MANUFACTURER AND ARE BEING RESOLD BY THERMACUT. THERMACUT RESERVES THE RIGHT TO SUBSTITUTE OEM PARTS IN PLACE OF THERMACUT PARTS. VALID FROM MAY 2016 • PREVIOUS VERSION IS NO LONGER VALID. • © COPYRIGHT 2016 BY THERMACUT® CZECH REPUBLIC. ALL RIGHTS RESERVED.