

REPLACEMENT PARTS SUITABLE FOR TRAFIMET®

A140/P140

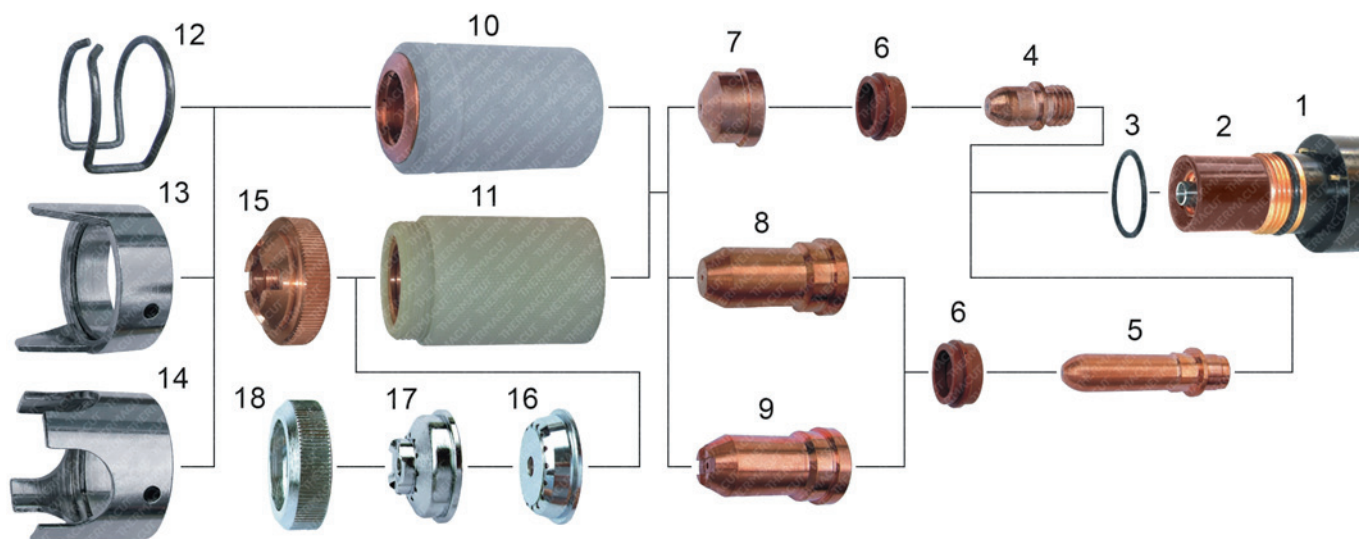

| Item | Part No. | Ref. No. | Description | Std. Pkg. | Item | Part No. | Ref. No. | Description | Std. Pkg. |
|------|----------|----------|---|-----------|------|----------|--------------------|---|-----------|
| 1. | TN-0109 | PF101 | Torch Body, Hand | 1 | 11. | T-5013 | PC103 | Contact Nozzle Ret. Cap | 1 |
| | TN-0106 | PF102 | Torch Body, Machine | 1 | 12. | T-3718 | CV11 | Spacer Spring | 5 |
| 2. | T-11114 | 60080 | Insulator brown [present torch design with brown insulator] | 1 | 13. | T-0643 | CV12(1408) | Double Pointed Spacer | 1 |
| | T-11289 | T-11289 | Insulator black [old TMT torch design with black insulator] | 1 | 14. | T-5003 | CV14 | Crown Spacer | 6 |
| 3. | T-3562 | EA131 | O - Ring | 1 | 15. | T-5004 | CV23 | Shield Cup | 6 |
| 4. | T-5059 | PR101 | Electrode | 10 | 16. | T-9372 | | Shield Cup, Machine | 1 |
| 5. | T-5065 | PR116 | Electrode, Long – no thread | 5 | 17. | T-9370 | | Spacer for Contact Cutting | 1 |
| 6. | T-5072 | PE101 | Swirl Ring | 2 | 18. | T-9375 | | Locking Nut | 1 |
| 7. | T-2926 | PD101-11 | Nozzle 1.1mm | 5 | NS | T-5069 | TP12 | Insulating Sleeve | 1 |
| | T-3349 | PD101-14 | Nozzle 1.4mm | 5 | NS | T-5068 | TP10 | Handle with Switch | 1 |
| | T-2955 | PD101-17 | Nozzle 1.7mm | 5 | NS | KT-1100 | PH148 | A140® Cable Leads 6m, Hand, fittings | 1 |
| | T-2954 | PD101-19 | Nozzle 1.9mm | 5 | NS | KT-1219 | PA101 | A140® Hand Torch with Leads 6m, fittings | 1 |
| 8. | T-5032 | PD117-14 | Nozzle, Long 1.4mm | 10 | NS | KT-1050 | PA214 | A140® Hand Torch with Leads 6m, centr.conn. | 1 |
| | T-5033 | PD117-17 | Nozzle, Long 1.7mm | 10 | NS | KT-1053 | PA219 | A140® Hand Torch with Leads 12m, centr.conn. | 1 |
| | T-5034 | PD117-19 | Nozzle, Long 1,9mm | 10 | NS | KT-1260 | K.P140-M,8,5M.CK.K | P140® Cable Leads 8,5m, Hand/Mach., fittings | 1 |
| 9. | T-9527 | PD111 | Nozzle, Gouging | 1 | NS | KT-1119 | PA146 | P140® Mach. Torch with Leads 12m, centr.conn. | 1 |
| 10. | T-10409 | PC101 | Nozzle Retaining Cap | 1 | | | | | |

NS NOT SHOWN IN THE PICTURE

Last update of this page: 29/12/2015. See Revision history for details.

THERMACUT®
THE CUTTING COMPANY

WWW.THERMACUT.CZ
TEL.: +420.556 423 418
SALES@THERMACUT.CZ

WWW.THERMACUT.DE
TEL.: +49 (0) 27 39 40 33 0
INFO@THERMACUT.DE

WWW.THERMACUT.COM
TEL.: 1-603-542-6715
CUSTOMERSERVICE@THERMACUT.COM

THERMACUT®, FHT-EX® AND EX-TRAFIRE® ARE REGISTERED TRADEMARKS OF THERMACUT S. R. O. AND MAY BE REGISTERED IN CZECH REPUBLIC AND/OR OTHER COUNTRIES. ALL OTHER TRADEMARKS ARE PROPERTIES OF THEIR RESPECTIVE OWNERS. THERMACUT IS NO WAY AFFILIATED WITH TRAFIMET®. MOST THERMACUT PARTS ARE MADE FOR OR BY AN IBG COMPANY. PARTS INDICATED WITH A OEM ARE ORIGINAL PARTS MANUFACTURED BY THE ABOVE NAMED MANUFACTURER AND ARE BEING RESOLD BY THERMACUT. THERMACUT RESERVES THE RIGHT TO SUBSTITUTE OEM PARTS IN PLACE OF THERMACUT PARTS. VALID FROM MAY 2016 • PREVIOUS VERSION IS NO LONGER VALID. • © COPYRIGHT 2016 BY THERMACUT® CZECH REPUBLIC. ALL RIGHTS RESERVED.